

1. Do not scale off this drawing - use figured dimensions only. All dimensions shown are to structural wall face i.e. do not include plaster/plasterboard. All dimensions to be checked before starting work.
 2. To be read in conjunction with CG Fry Materials Schedule, CG Fry Construction Specification, CG Fry Construction details, Structural Engineers drawings, services drawings, Floor manufacturers drawings, Roof truss drawings, kitchen and wardrobe suppliers drawings.

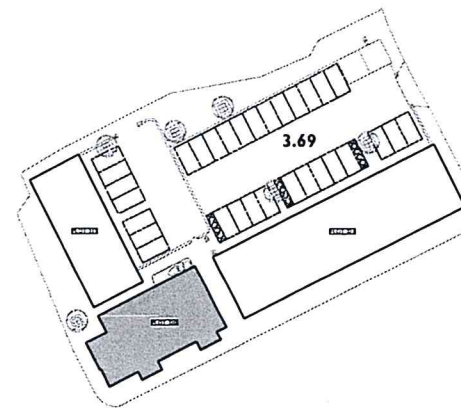

POUNDBURY NORTH EAST QUADRANT
 SECTION 3.69 KEY PLAN
 (NOT TO SCALE)

KEY TO ELECTRICAL SYMBOLS - COMMERCIAL

	DOUBLE 13amp SWITCHED SOCKET, 450mm above floor level generally, above floor level in kitchenette.
	DATA SOCKET, 450mm above FFL
	Standard fire exit sign positioned above door as indicated on plans. Lighting to be located nearby.
	MANUAL CALL POINT. Generally positioned at exits.
	FIRE ALARM SYSTEM PANEL. To be visible from outside of unit with door shut as latest relevant BS standard.
	ELECTRIC PANEL HEATER POSITION
	ELECTRIC PANEL HEATER PROGRAMMER
	13amp MASTER SOCKET, 450mm above FFL
	1 WAY LIGHT SWITCH, mounted 1050 above FFL
	2 WAY LIGHT SWITCH (mounted 1050mm above FFL)
	3 WAY LIGHT SWITCH (mounted 1050mm above FFL)
	CONSUMER UNIT - MINATURE CIRCUIT BREAKERS (switch to be positioned between 1350-1450mm above FFL)
	TELEPHONE POINT (450mm above FFL; 1050mm above FFL in kitchenette - provide 150mm dia duct with chase going to point - recessed box + blanking plate)
	DATA HUB located within store cupboard
	FAS: EXTRACT VENTILATION System 3 - Vorlux MEV using 100mm rigid ducting (100mm holes). Extract fan in accordance with Vent Area commissioning table.
	MULTI-GANG SWITCH PANEL to control all white goods in kitchen. (Fit above worktop, with permanent labelling)
	DOUBLE SOCKET FOR FRIDGE-FREEZER (unswitched below worktop level with isolating switch 600mm above FFL)
	SINGLE SOCKET FOR DISHWASHER (unswitched below worktop level with isolating switch 600mm above FFL)
	Occupancy Sensor Lighting to Disabled WC and Kitchenette
	HEAT DETECTOR interlinked to smoke alarm
	CEILING PULLCORD ALARM. Pullcord to have 2 red bangles one at 100 the other at 800 to 1000 above floor level.
	SPRINKLER to specialist design
EXTERNAL LIGHTING (INCLUDING EMERGENCY FITTINGS) TO ENTRANCES AND INTERNAL AREAS OF COMMERCIAL UNITS TO BE DESIGNED AND INSTALLED BY SPECIALIST ELECTRICAL CONTRACTOR IN ACCORDANCE WITH THE LATEST EDITIONS OF THE RELEVANT BUILDING REGULATIONS AND BRITISH STANDARDS.	
DESIGN AND INSTALLATION OF FIRE ALARM SYSTEM TO BE DESIGNED BY SPECIALIST ELECTRICAL CONTRACTOR IN ACCORDANCE WITH THE LATEST EDITIONS OF THE RELEVANT BUILDING REGULATIONS AND BRITISH STANDARDS.	

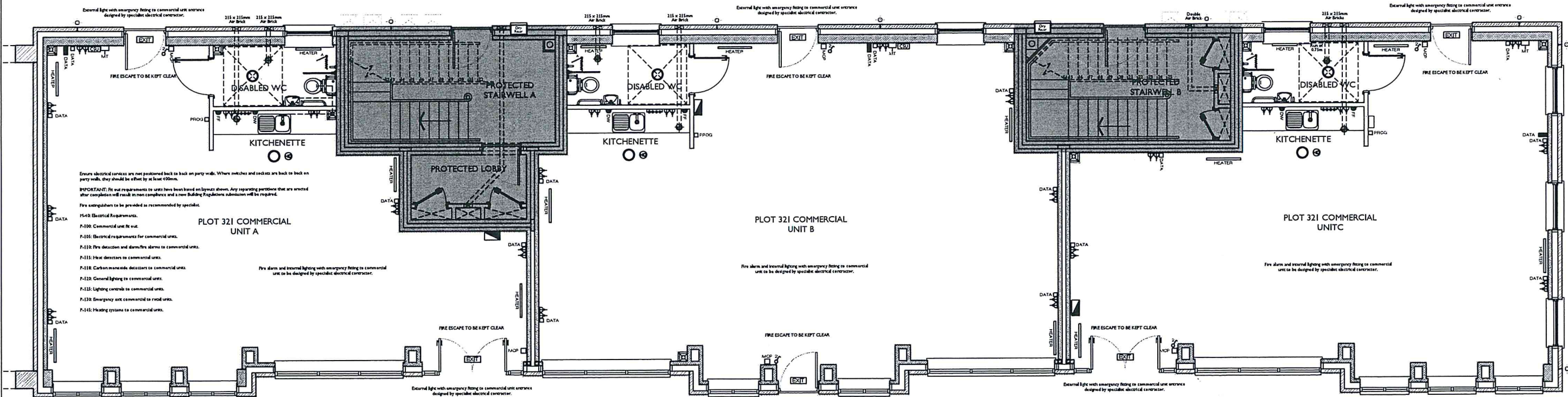

Ensures electrical services are not positioned back to back on party walls. Where switches and sockets are back to back on party walls, they should be offset by at least 400mm.
 IMPORTANT: Fit and requirements to units have been based on layouts shown. Any separating partitions that are erected after completion will result in non-compliance and a new Building Regulations submission will be required.
 Fire extinguishers to be provided as recommended by specialist.
 F-102 Electrical Requirements.
 F-100 Commercial unit fit out.
 F-101 Electrical requirements for commercial units.
 F-110 Fire detection and alarm/fire alarm to commercial units.
 F-111 Heat detectors to commercial units.
 F-112 Carbon monoxide detectors to commercial units.
 F-113 General lighting to commercial units.
 F-114 Lighting controls to commercial units.
 F-115 Emergency exit commercial to retail units.
 F-116 Heating systems to commercial units.

PLOT 321 COMM. A
 Gross Internal Floor Area: 79.65m²

PLOT 321 COMM. B
 Gross Internal Floor Area: 103.53m²

PLOT 321 COMM. C
 Gross Internal Floor Area: 87.06m²